

THE LARGEST DISPLAY OF  
**TROPICAL ORCHIDS**  
IN THE WORLD

**LEGEND:**

- TROPICAL MONTANE ORCHIDETUM
- TICKET COUNTER    STAIRS
- REFRESHMENT    SHELTER
- GARDENS SHOP    TRELLIS
- RESTROOM    HANDICAPPED TOILET
- DRINKING WATER    NURSING ROOM
- RECOMMENDED ROUTE (Wheelchair-friendly)
- Loan of wheelchair available at Ticket Counter

Facilities at Burkill Hall  
- Wheelchair-accessible Changing Room  
- Family Room

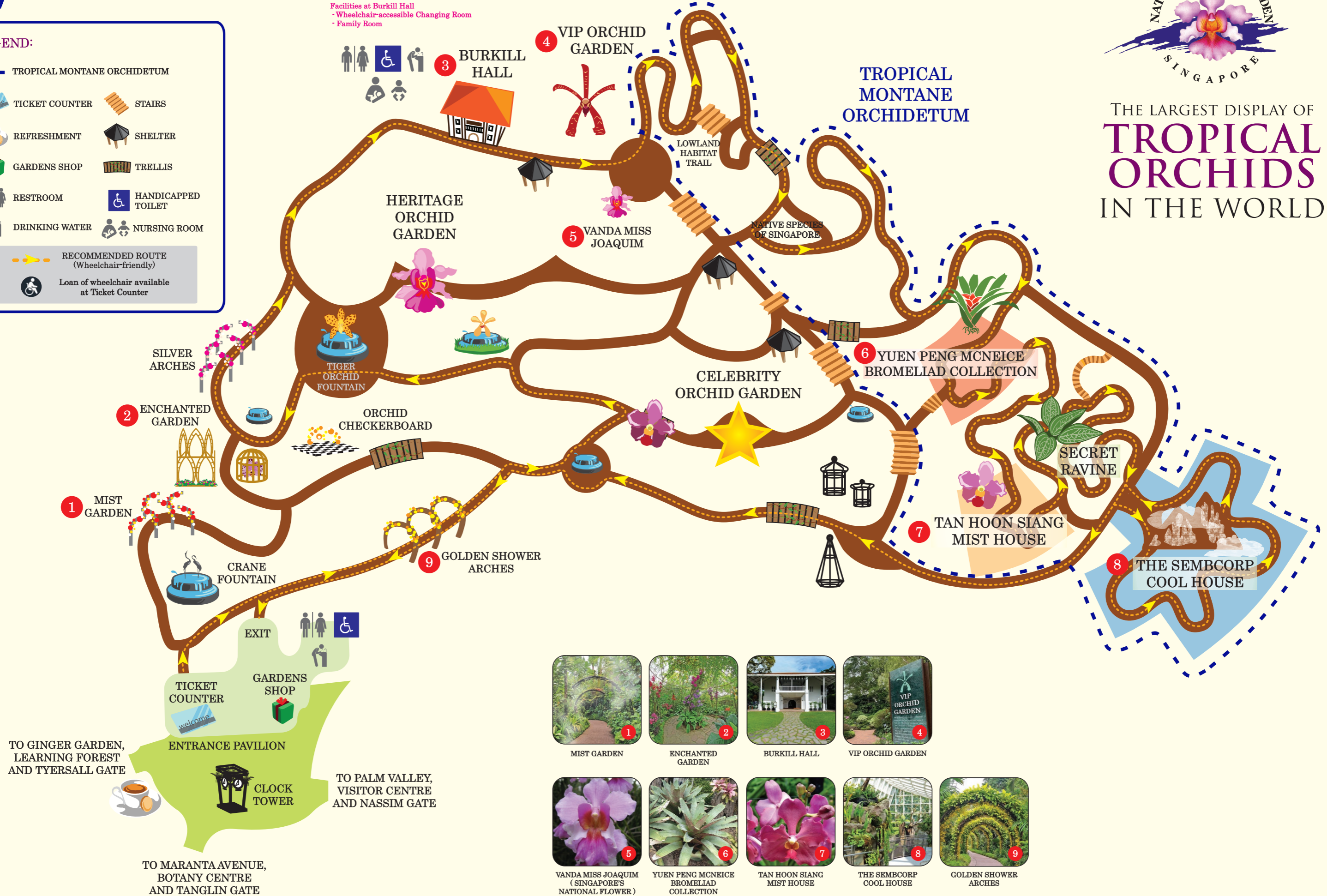

TO GINGER GARDEN,  
LEARNING FOREST  
AND TYERSALL GATE

TO MARANTA AVENUE,  
BOTANY CENTRE  
AND TANGLIN GATE

TO PALM VALLEY,  
VISITOR CENTRE  
AND NASSIM GATE

